

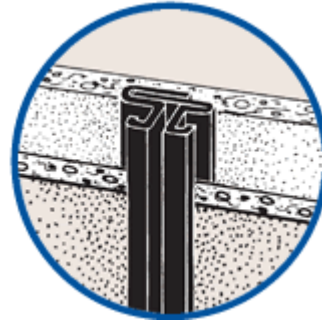

“Specialists in Expanded Metal Building Products”

NILES TWO-PIECE TRU-JOINT



Niles Two-Piece Tru-Joint	Length	Ctns/Pallet	Nominal Lbs/Ctn	Nominal Lbs/Plt
1/2"	10'	25	61	1525
3/4"	10'	25	65	1625
7/8"	10'	25	67	1675

15pcs/ctn – 150' per ctn

The Niles Two-Piece Tru-Joint is used to relieve stress caused by expansion and contraction and initial stucco shrinkage. The opening adjusts from 1/4" to 5/8" and is ideally used where more movement is expected than would be normal with a one-piece expansion control joint.

ASTM C653 - Standard specification for steel sheet, zinc-coated (galvanized) or zinc-iron alloy coated (galvannealed) by the hot-dip process.

ASTM C841 - Standard specification for installation of interior lathing and furring.

ASTM C1047 - Standard specification for gypsum wallboard and gypsum veneer base accessories

ASTM C1063 - Standard specification for installation of lathing and furring for portland cement-based plaster

NILES BUILDING PRODUCTS CO.

Company Headquarters
1600 Hunter Street
Niles, Oh 44446

Dallas/Fort Worth Service Center
6400 Wuliger, Ste A
North Richland Hills, TX 76180

Southeast Distribution Center
1325 Cobb International Dr
Kennesaw, GA 30152

Phone: 800-323-3329
Fax: 330-544-8868

www.nilesbldg.com